

- CEILING NOTES:**
1. TYPICAL GYPSUM BULKHEAD W/O ACOUSTIC INSULATION
  2. CEILING TYPE C1 W ACOUSTIC INSULATION AT BATHROOMS AND LAUNDRY CLOSETS TYP.
  3. KITCHEN BULKHEAD @ 2450mm AFF TYP. U.N.O. (@ 2200mm AFF ON LEVELS 3 AND 4)
  4. ALL PLUMBING PENETRATING SLAB ABOVE TO BE WRAPPED W/ 50mm ACOUSTIC BATT EXCEPT IN BATHROOM CEILINGS.
  5. PARTITIONS AROUND C1 CEILINGS TO BE FILLED W/ ACOUSTIC BATT ABOVE THE CEILING. EXTEND GYPSUM TO US SLAB ABOVE ON ONE SIDE OF PARTITION WALL.
  6. WHERE PLUMBING FROM ABOVE IS LOCATED OVER A ROOM BELOW OTHER THAN A BATHROOM, PROVIDE AN INSULATED C1 CEILING, PLUS WRAP THE PLUMBING IN ACOUSTIC BATT.

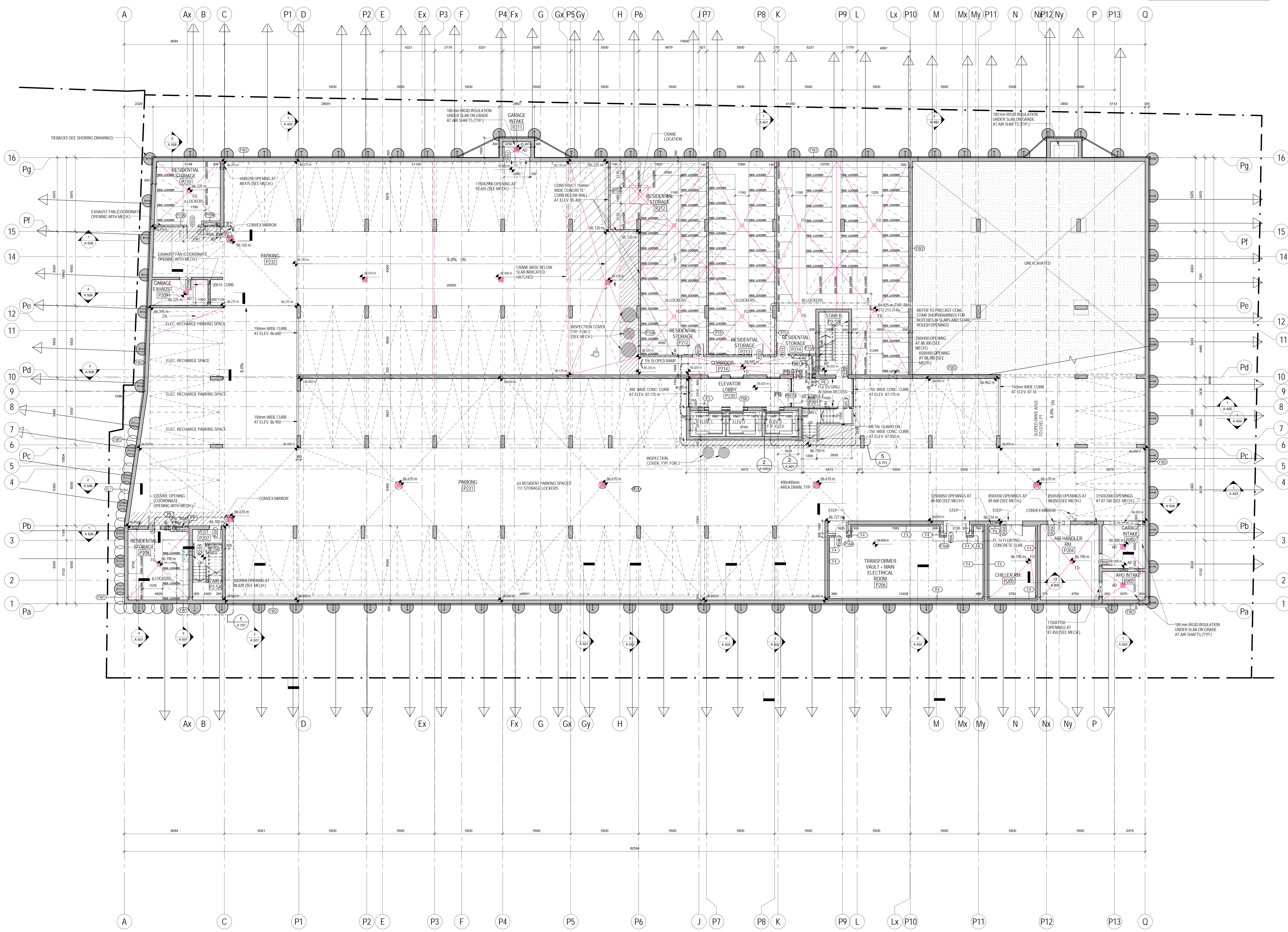

**METRIC SCALE DRAWING**  
FIRST FLOOR ELEV. +93.60m

No. ISSUED/REVISIONS FOR DATE:

1	Issued for SPA	2013-10-24
2	Issued for Coordination	2013-11-11
3	Issued for Coordination	2014-01-10
4	Revised by SPA	2014-01-10
5	Issued for Coordination	2014-02-18
6	Issued for Tender	2014-04-07
7	Issued for Coordination	2014-04-23
8	Issued for 10% Completion	2014-05-21
9	Issued for Permit	2014-05-21
10	Issued for Coordination	2014-06-23
11	Revised by Permit	2014-07-10
12	Revised for Permit	2014-08-22
13	Issued for Tender	2014-08-28
14	Issued for Tender	2014-08-28
15	Issued for Flaming Tender	2015-03-30
16	Issued for 40% C	2015-03-31
17	Issued for Coordination	2015-04-29
18	Issued for Tender	2015-05-04
19	Issued for Tender	2015-05-05
20	Issued for 40% C	2015-05-05
21	Issued for Final Tender	2015-06-19

**SQ ALEXANDRA PARK - BLOCK 11**  
38 CAMERON ST., TORONTO, ONTARIO M5T 2H2

project no. 12-115  
scale: As indicated  
drawn by: TA  
reviewed by:  
date: 2014-09-22

**Teepie Architects**  
LEVEL P2 PLAN

1 PARKING LEVEL P2  
A 201 1:100

A 201