

THIS DRAWING IS THE PROPERTY OF SQ SPADINA QUEEN TRIDEL. IT IS TO BE USED FOR THE PROJECT AND SITE SPECIFICALLY IDENTIFIED HEREIN. IT IS NOT TO BE REPRODUCED, COPIED, REPRODUCED, OR TRANSMITTED IN ANY FORM OR BY ANY MEANS, ELECTRONIC OR MECHANICAL, INCLUDING PHOTOCOPYING, RECORDING, OR BY ANY INFORMATION STORAGE AND RETRIEVAL SYSTEM, WITHOUT THE WRITTEN PERMISSION OF SQ SPADINA QUEEN TRIDEL. THE USER OF THIS DRAWING SHALL BE RESPONSIBLE FOR OBTAINING ALL NECESSARY PERMITS AND APPROVALS FROM THE APPROPRIATE AUTHORITIES. THE USER SHALL BE RESPONSIBLE FOR OBTAINING ALL NECESSARY PERMITS AND APPROVALS FROM THE APPROPRIATE AUTHORITIES. THE USER SHALL BE RESPONSIBLE FOR OBTAINING ALL NECESSARY PERMITS AND APPROVALS FROM THE APPROPRIATE AUTHORITIES.

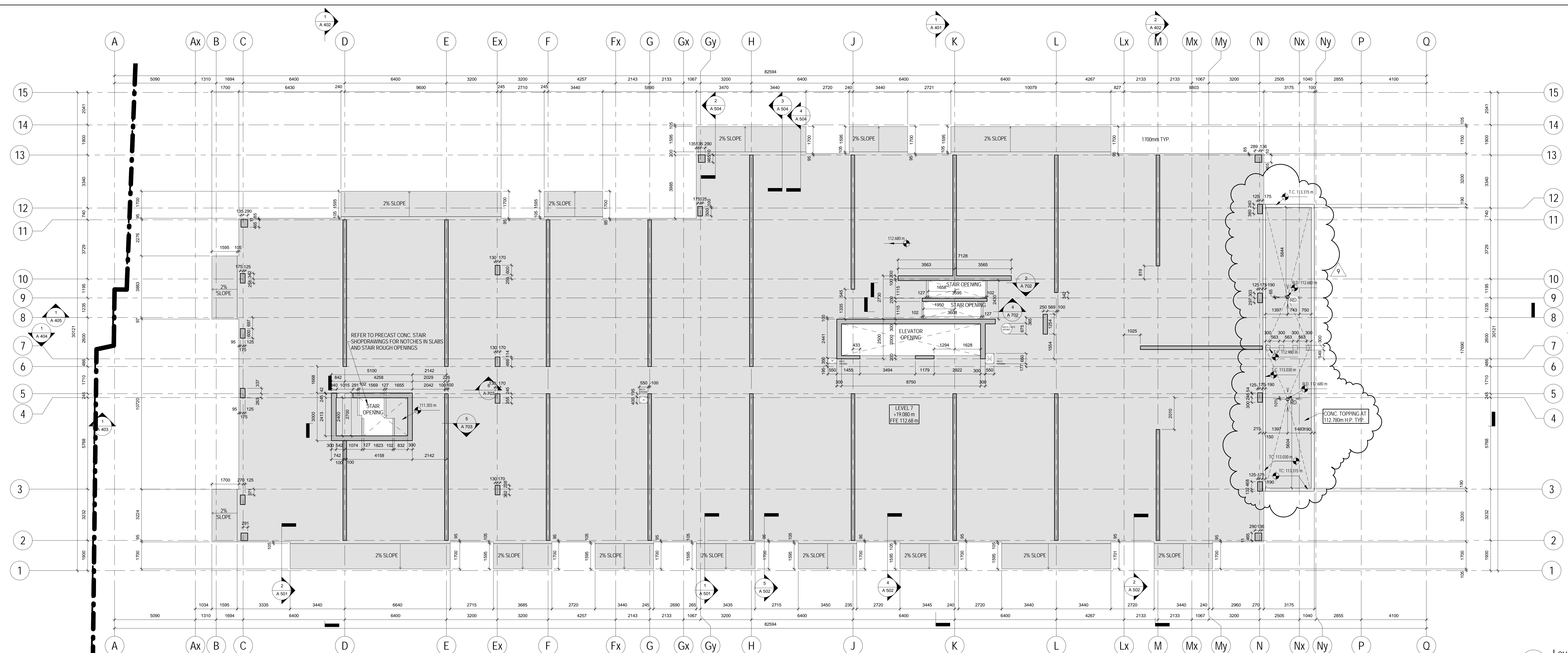

1 Level 7 EOS
1/A227 1:100

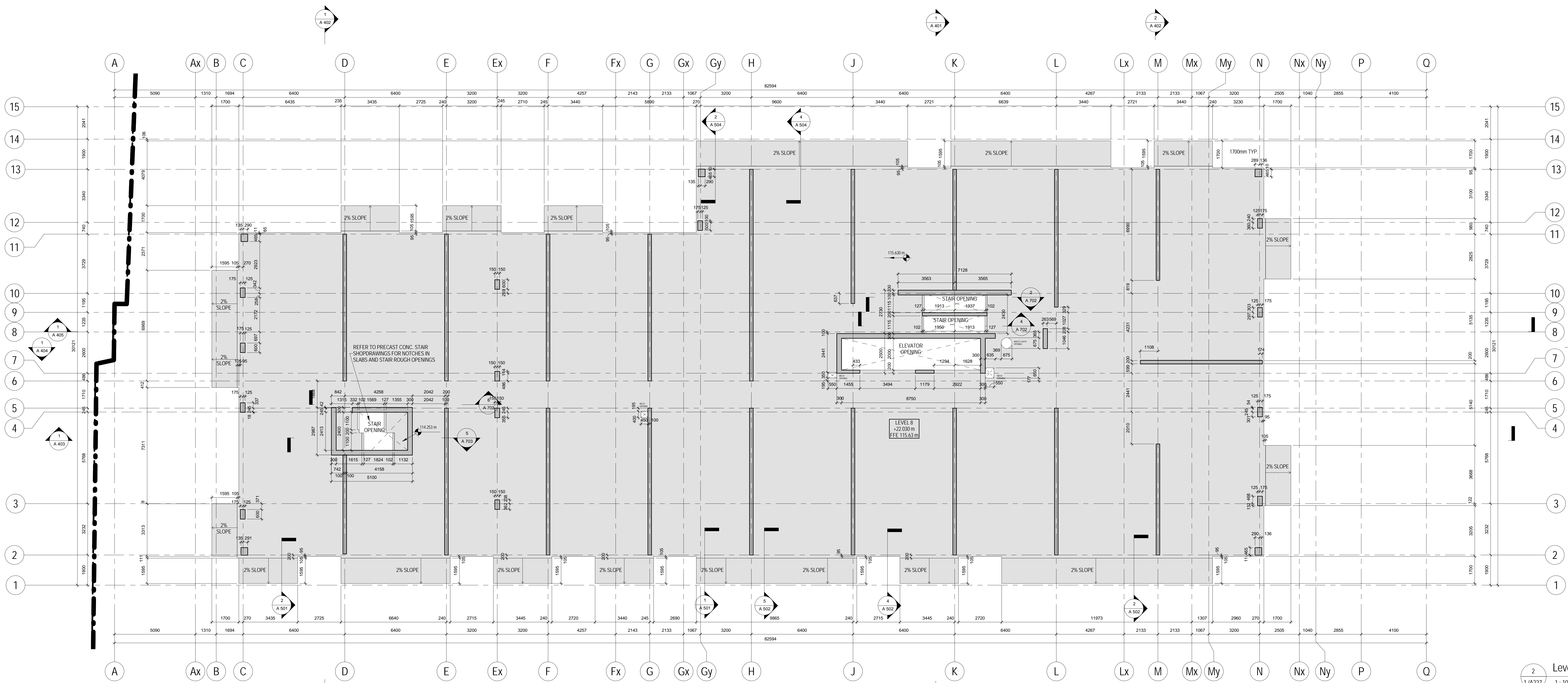

2 Level 8 EOS
1/A227 1:100

METRIC SCALE DRAWING
FIRST FLOOR ELEV. +93.60m

No.	ISSUED/REVISIONS FOR	DATE
1	Issued for Coordination	2014-06-23
2	Issued for Tender	2014-08-26
3	Issued for Tender	2014-09-23
4	Issued for Tender	2015-05-05
5	Issued for RFP	2015-05-17
6	Issued for RFP	2015-07-21
7	Issued for General Tender Add #1	2015-08-14
8	Issued for RFP	2015-08-17
9	Issued for RFP	2015-09-23

SQ ALEXANDRA PARK - BLOCK 11
38 CAMERON ST. TORONTO, ONTARIO M5T 2H2

project no. 13-115
scale: 1:100
drawn by: T4
reviewed by: SA
date: 2014-09-23

Tepple Architects
1200 BAY ST. TORONTO, ONTARIO M5S 1A5
LEVEL 7 & 8 EOS PLAN