

LEGEND : POWER		
SYMBOL	DESCRIPTION	QTY
⊕	120 VOLTS DUPLEX OUTLET TO BE WALL MOUNTED @ 12" AFF. U.C. UNLESS OTHERWISE NOTED	-
⊕	120 VOLTS DUPLEX OUTLET W/ GROUND FAULT INTERRUPTER TO BE WALL MOUNTED @ 12" AFF. U.C. UNLESS OTHERWISE NOTED	-
⊕	TELEPHONE OUTLET TO BE WALL MOUNTED AS NOTED (U.C. UNLESS OTHERWISE NOTED)	-
⊕	DATA OUTLET TO BE WALL MOUNTED (CAT5 DATA)	-
⊕	DEDICATED OUTLET FOR COMPUTER TO BE WALL MOUNTED @ 12" AFF. U.C. UNLESS OTHERWISE NOTED	-
⊕	FLOOR MOUNTED DISCREET OUTLET @ CASH AREA FOR COMPUTER	-
⊕	FLOOR MOUNTED DUPLEX OUTLET	-
⊕	FLOOR MOUNTED TELEPHONE OUTLET @ CASH AREA (CAT3 VOICE)	-
⊕	FLOOR MOUNTED DATA OUTLET @ CASH AREA (CAT5 DATA)	-
*	POWER REQUIRED	-
⊕	SPEAKER - WIRE TO OFFICE STEREO UNIT. CONTRACTOR TO PROVIDE ONLY IF NONE EXISTS	-
⊕	EXISTING DUPLEX OUTLETS AND POWER TO REMAIN	-
⊕	CABLE TELEVISION OUTLET	-
⊕	AUTOMATIC DOOR OPERATOR PUSH PLATE/BUTTON MOUNTED AT 1050mm	-
⊕	CARD READER	-
⊕	ELECTRIC STRIKE	-
⊕	DURESS ALERT PUSH PLATE/BUTTON MOUNTED AT 1050mm	-
⊕	INTERCOM MOUNTED AT AT 1050mm	-

- POWER AND COMMUNICATION NOTES**
- POWER AND COMMUNICATION DRAWINGS TO BE USED FOR LOCATION PURPOSES ONLY. REFER TO ELECTRICAL ENGINEERING DRAWING FOR LOCATION, SPECIFICATIONS AND REQUIREMENTS.
 - ELECTRICAL AND COMMUNICATION WORK TO COMPLY WITH THE REQUIREMENTS OF THE BUILDING LAWS AND APPLICABLE MARK JURISDICTION.
 - CONTRACTOR TO REPORT DISCREPANCIES BETWEEN ENGINEERING AND DESIGN DRAWINGS TO THE DESIGNER AND ELECTRICAL ENGINEER PRIOR TO COMMENCEMENT OF WORK.
 - SOBMIT REQUIRED CHANGES TO THE DESIGNER FOR APPROVAL PRIOR TO COMMENCEMENT OF WORK.
 - DIMENSIONS OF SERVICES ARE TAKEN AT THE CENTRE OF THE SERVICE OR GROUP OF SERVICES UNLESS OTHERWISE NOTED.
 - DIMENSIONS FROM A PARTITION ARE TAKEN FROM FACE OF PARTITION TO CENTRE OF THE SERVICE OR GROUP OF SERVICES UNLESS OTHERWISE NOTED.
 - DIMENSIONS FROM THE PERIMETER OF THE BUILDING ARE TAKEN FROM FACE OF THE CORNER OR BASE BUILDING ELEMENT TO CENTRE OF THE SERVICE OR GROUP OF SERVICES UNLESS OTHERWISE NOTED.
 - REFER TO ENGINEERING DRAWINGS FOR SPECIFICATION OF COVER PLATE, ACCEPTABLE TYPE AND COLOUR. REFER TO DESIGNER DRAWINGS FOR MOUNTING HEIGHT.
 - WHERE POWER AND COMMUNICATION SERVICES ARE ADJACENT ON PLAIN GANGED COVER PLATES SHALL BE USED.
 - CONTRACTOR TO ENSURE THAT TRUNKS HAVE COMPLETED THEIR PORTION OF THE WORK BEFORE BANKING UP BOTH SIDES OF THE TRUNK. THIS IS TO INCLUDE INSPECTIONS AS REQUIRED BY LOCAL AND PROVINCIAL BY-LAW AND BUILDING CODES.
 - SOUND BATS IN PARTITIONS ARE TO CONTINUE BEHIND POWER AND TELEPHONE OUTLETS WITHOUT INTERRUPTION.
 - STAGGER OUTLETS OCCURRING ON OPPOSITE SIDES OF THE SAME PARTITION TO MAINTAIN AESTHETIC INTEGRITY.
 - FURNITURE SYSTEM FEEDS TO BE SUPPLIED BY SYSTEMS FURNITURE MANUFACTURER AND ELECTRICAL CONNECTION BY SYSTEMS FURNITURE BY ELECTRICAL CONTRACTOR.
 - CONTRACTOR TO SUPPLY, INSTALL, CONNECT AND VERIFY SECURITY ACCESS CONTROL EQUIPMENT INCLUDING THE SUPPLY AND INSTALLATION OF BOXES, CONDUITS, WIRING AND CABLES AS PER SECURITY CONSULTANT'S SPECIFICATIONS AND DETAILS.
 - TRUNK WALL OUTLETS TO BE MOUNTED AT 12" AFF.
 - REFER TO MECHANICAL & ELECTRICAL ENGINEER'S DRAWINGS FOR SPECIFICATIONS.
 - ALL POWER SHOWN ON THIS PLAN TO BE COORDINATED AND APPROVED BY CLIENT PRIOR TO INSTALLATION AND FABRICATION OF ANY MILLWORK WITH POWER REQUIREMENTS.
 - CONTRACTOR SHALL CONFIRM ALL QUANTITIES PRIOR TO ORDERING.
 - CONTRACTOR IS RESPONSIBLE FOR:
 - DISCONNECTING ALL LIGHTING, COMPUTERS, DATA LINES, PHONE LINES, ELECTRICAL FIXTURES, ETC.
 - REMOVAL AND RELOCATION OF EXISTING ELECTRICAL AS REQUIRED.
 - REMOVING ALL EXISTING FLAME RETARDANT SYSTEMS UNDER EXISTING FLOORING/CEILING IF REQUIRED.
 - CLIENT IS RESPONSIBLE FOR ALL PDS AND SOBMIT WORKING.
 - THE ELECTRICAL CONTRACTOR MUST VISIT THE SITE AND DO TAKE OFF ON QUANTITY AND MATERIALS REQUIRED BEFORE STARTING PROJECT. ALL FUTURE LAYOUTS AND ELECTRICAL WORK SHOWN ARE TO BE CONFIRMED ON SITE AND DESIGNER NOTIFIED IF THERE ARE ANY DISCREPANCIES.

- Notes:**
- CONTRACTOR AND ALL SUB-TRADES SHALL VERIFY ALL SITE DIMENSIONS. ALL DRAWINGS, DETAILS AND SPECIFICATIONS AND REPORT ANY DISCREPANCIES TO THE INTERIOR DESIGNER IN WRITING FOR APPROVAL BEFORE PROCEEDING WITH THE WORK.
 - CONTRACTOR AND SUB-CONTRACTORS, BEFORE PROCEEDING WITH WORK, MUST SUBMIT ALL NECESSARY SAMPLES FOR APPROVAL OF QUALITY AND FINISH TO THE INTERIOR DESIGNER.
 - CONTRACTOR MUST COMPLY WITH THE CONTRACT DOCUMENTS, PERFORMANCE REQUIREMENTS, APPLICABLE CODES AND REGULATIONS.
 - ALL DRAWINGS AND WRITTEN MATERIAL HEREIN CONSTITUTE THE ORIGINAL AND UNPUBLISHED WORK OF "IBBY DESIGN ASSOCIATES INC." AND MAY NOT BE DUPLICATED, USED OR DISCLOSED WITHOUT PRIOR WRITTEN CONSENT OF "IBBY DESIGN ASSOCIATES INC."
 - DRAWINGS NOT TO BE SCALED
- Issue:**
- | | |
|-----------------------------|----------|
| 05 ISSUED FOR COORDINATION | 16.01.11 |
| 06 ISSUED FOR CLIENT REVIEW | 16.01.15 |
| 07 ISSUED FOR TENDER | 16.03.18 |
| 09 ISSUED FOR ADDENDUM | 17.01.27 |
| 10 ISSUED FOR CONSTRUCTION | 17.06.19 |
| 14 SITE INSTRUCTION #04 | 18.03.07 |
| 23 SITE INSTRUCTION #15 | 18.11.09 |
| - | - |
| - | - |
| - | - |
| - | - |
| - | - |

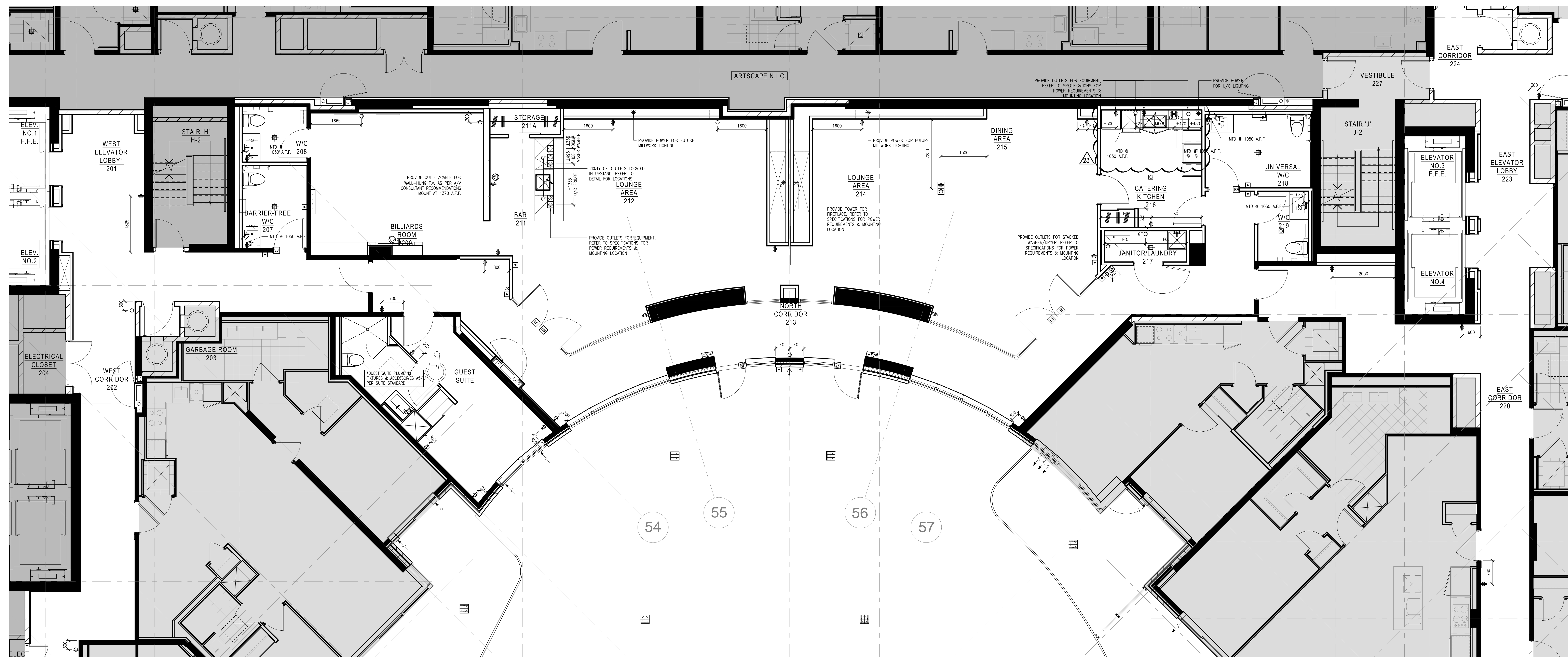

1 POWER AND COMMUNICATION PLAN
 (04.84) SCALE: 1:50

Hines TRIDEL

AQUAVISTA
 AT BAYSIDE TORONTO
 1 EDgewater Drive, Toronto Ontario

IBBY DESIGN
 77 MOWAT AVENUE, SUITE 100
 TORONTO, ONTARIO M5K 3G2 - CANADA
 T + 1 416 531 2224
 12 DEBROSS STREET
 NEW YORK, NEW YORK 10013 - USA
 T + 1 212 392 4952

Drawing Title:
**LEVEL 2
 POWER AND
 COMMUNICATION PLAN**

Our Project Number:
 14008
 Designed By: DMJ/R, VVJ/SJ
 Drawn By: DMJ/R, VVJ/SJ, BP

Drawing Number:
ID4.8A