

LEGEND : DRAWING SYMBOLS	
SYMBOL	DESCRIPTION
	WALL FINISH REFER TO 11" X 17" FINISH SPECIFICATIONS

FINISHES NOTES	
1. CONTRACTOR TO PROVIDE DRAW-INGS OF EACH PAINT COLOUR TO BE FOR DESIGNER'S APPROVAL PRIOR TO COMMENCEMENT OF WORK.	
2. ALL NEW MATERIALS FOR INSULATION, FINISHING AND SEALING ARE TO BE SELECTED TO MANUFACTURER'S BEST INSTRUCTIONS AND SPECIFICATIONS FOR APPLICATION AND METHOD OF JOINTS.	
3. ALL MATERIALS LISTED TO BE USED AS ALTERNATIVES TO BE SUBMITTED TO DESIGNER FOR APPROVAL PRIOR TO ORDERING AND INSTALLATION.	
4. CONTRACTOR TO ENSURE THAT ALL DRYWALL IS FLUSH, CLEAN AND FREE FROM DUST PRIOR TO APPLICATION OF ALL WALL FINISHES.	
5. ALLOW FOR PAINT TOUCH-UPS AFTER MILLWORK AND FURNITURE INSTALLATION.	
6. ALL NEW PARTITIONS AND EXISTING BASE BUILDING SURFACES REQUIRING REPAIR SHALL BE PRIMED AND RECEIVE 2 COATS OF FINISH PAINT SPECIFIED.	
7. ALL FIRE HOSE CABINETS AND FRAMING TO BE FINISHED WITH SEMI-GLOSS PAINT.	
8. CONTRACTOR TO MAKE SITE LEVEL AND READY TO ACCEPT INSTALLATION OF ALL FLOOR FINISHES. 5MM FLOOR AS REQUIRED TO ENSURE LEVEL SURFACE.	
9. PROVIDE MANUFACTURER'S MAINTENANCE DATA FOR ALL FINISHES TO CLIENT AT THE COMPLETION OF THE PROJECT.	
10. REMOVE EXCESS ADHESIVE FROM VINYL FLOOR, BASE AND WALL SURFACES WITHOUT DAMAGE. CLEAN, SEAL AND WAX FLOOR AND BASE SURFACES TO FLOORING MANUFACTURER'S INSTRUCTIONS.	
11. GENERAL CONTRACTOR TO COORDINATE INSTALLATION OF CARPET WITH INSTALLATION OF OTHER FLOOR AND BASE MATERIALS.	
12. TRANSITION BETWEEN ONE CARPET TYPE AND ANOTHER OR BETWEEN FLOOR FINISHES AT DOOR WILL OCCUR DIRECTLY BELOW THE DOOR (IN CLOSED POSITION). NEW THRESHOLDS TO BE APPROVED BY DESIGNER PRIOR TO INSTALLATION.	
13. CONTRACTOR TO PROVIDE CARPET SEAMING TO DESIGNER FOR REVIEW.	
14. QUICK RELEASE ADHESIVE IS TO BE USED FOR CARPET INSTALLATION.	

Notes:

- CONTRACTOR AND ALL SUB-TRADES SHALL VERIFY ALL SITE DIMENSIONS. ALL DRAWINGS, DETAILS AND SPECIFICATIONS AND REPORT ANY DISCREPANCIES TO THE INTERIOR DESIGNER IN WRITING FOR APPROVAL BEFORE PROCEEDING WITH THE WORK.
- CONTRACTOR AND SUB-CONTRACTORS, BEFORE PROCEEDING WITH WORK, MUST SUBMIT ALL NECESSARY SAMPLES FOR APPROVAL OF QUALITY AND FINISH TO THE INTERIOR DESIGNER.
- CONTRACTOR MUST COMPLY WITH THE CONTRACT DOCUMENTS, PERFORMANCE REQUIREMENTS, APPLICABLE CODES AND REGULATIONS.
- ALL DRAWINGS AND WRITTEN MATERIAL HEREIN CONSTITUTE THE ORIGINAL AND UNPUBLISHED WORK OF 18 BY IV DESIGN ASSOCIATES INC. AND MAY NOT BE DUPLICATED, USED OR DISCLOSED WITHOUT PRIOR WRITTEN CONSENT OF 18 BY IV DESIGN ASSOCIATES INC.
- DRAWINGS NOT TO BE SCALED.

Issue:

08 ISSUED FOR CLIENT REVIEW	16.01.15
07 ISSUED FOR TENDER	16.03.15
10 ISSUED FOR CONSTRUCTION	17.06.19
12 SITE INSTRUCTION #02	17.07.26
-	-
-	-
-	-
-	-
-	-
-	-
-	-
-	-

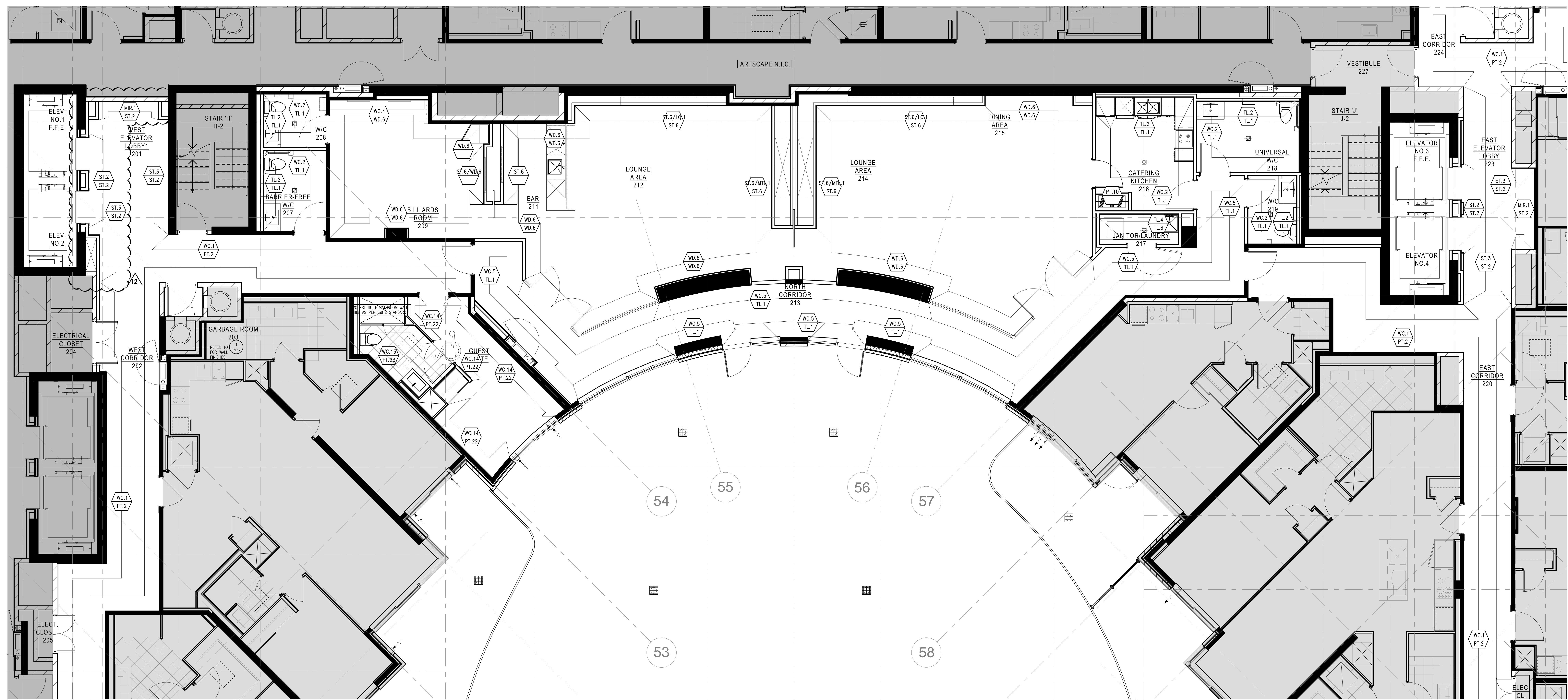

1 WALL FINISH PLAN
SCALE 1:50

Hines TRIDEL

AQUAVISTA
AT BAYSIDE TORONTO
1 EDgewater Drive, Toronto Ontario

77 MOWAT AVENUE, SUITE 100
TORONTO, ONTARIO M5K 3E3 - CANADA
T + 1 416 531 2224
12 DEBORCHES STREET
NEW YORK, NEW YORK 10013 - USA
T + 1 212 362 4852

Level 2
WALL FINISH PLAN

Our Project Number: 14008
Designed By: DMJ/R, VVJ/SJ
Drawing Number: DMJ/R, VVJ/SJ, BP

ID6.8A