

LEGEND : DRAWING SYMBOLS	
SYMBOL	DESCRIPTION
	FLOOR FINISH NUMBER REFER TO 11" x 17" FINISH SPECIFICATIONS

FINISHES NOTES	
1.	CONTRACTOR TO PROVIDE DRAWING OF EACH PAINT COLOUR TO 4 BY 8 FOR DESIGNER'S APPROVAL PRIOR TO COMMENCEMENT OF WORK.
2.	ALL NEW MATERIALS FOR INSTALLATION, FINISHES AND SEALING ARE TO BE EXECUTED TO MANUFACTURER'S BEST INSTRUCTIONS AND SPECIFICATIONS FOR APPLICATION AND INTENDED USAGE.
3.	CONTRACTOR TO MAKE SURE GOOD LEVEL AND READY TO ACCEPT INSTALLATION OF ALL FLOOR FINISHES. SAN FLOOR AS REQUIRED TO ENSURE LEVEL SURFACE.
4.	PROVIDE MANUFACTURER'S MAINTENANCE DATA FOR ALL FINISHES TO CLIENT AT THE COMPLETION OF THE PROJECT.
5.	REMOVE EXCESS ADHESIVE FROM VINYL FLOOR, BASE AND WALL SURFACES WITHOUT DAMAGE. CLEAN, SEAL AND WAX FLOOR AND BASE SURFACES TO FLOORING MANUFACTURER'S INSTRUCTIONS.
6.	GENERAL CONTRACTOR TO COORDINATE INSTALLATION OF CARPET WITH INSTALLATION OF OTHER FLOOR AND BASE MATERIALS.
7.	QUICK RELEASE ADHESIVE IS TO BE USED FOR CARPET INSTALLATION.

Notes:

- CONTRACTOR AND ALL SUB-TRADES SHALL VERIFY ALL SITE DIMENSIONS. ALL DRAWINGS, DETAILS AND SPECIFICATIONS AND REPORT ANY DISCREPANCIES TO THE INTERIOR DESIGNER IN WRITING FOR APPROVAL BEFORE PROCEEDING WITH THE WORK.
- CONTRACTOR AND SUB-CONTRACTORS, BEFORE PROCEEDING WITH WORK, MUST SUBMIT ALL NECESSARY SAMPLES FOR APPROVAL OF QUALITY AND FINISH TO THE INTERIOR DESIGNER.
- CONTRACTOR MUST COMPLY WITH THE CONTRACT DOCUMENTS, PERFORMANCE REQUIREMENTS, APPLICABLE CODES AND REGULATIONS.
- ALL DRAWINGS AND WRITTEN MATERIAL HEREIN CONSTITUTE THE ORIGINAL AND UNPUBLISHED WORK OF "I BY IV DESIGN ASSOCIATES INC." AND MAY NOT BE DUPLICATED, USED OR DISCLOSED WITHOUT PRIOR WRITTEN CONSENT OF "I BY IV DESIGN ASSOCIATES INC."
- DRAWINGS NOT TO BE SCALED.

Issue:

06 ISSUED FOR CLIENT REVIEW	16.01.15
07 ISSUED FOR TENDER	16.03.16
08 ISSUED FOR ADDENDUM	16.09.20
10 ISSUED FOR CONSTRUCTION	17.06.19
12 SITE INSTRUCTION #02	17.07.25
14 SITE INSTRUCTION #04	18.03.07
21 SITE INSTRUCTION #12	18.09.10

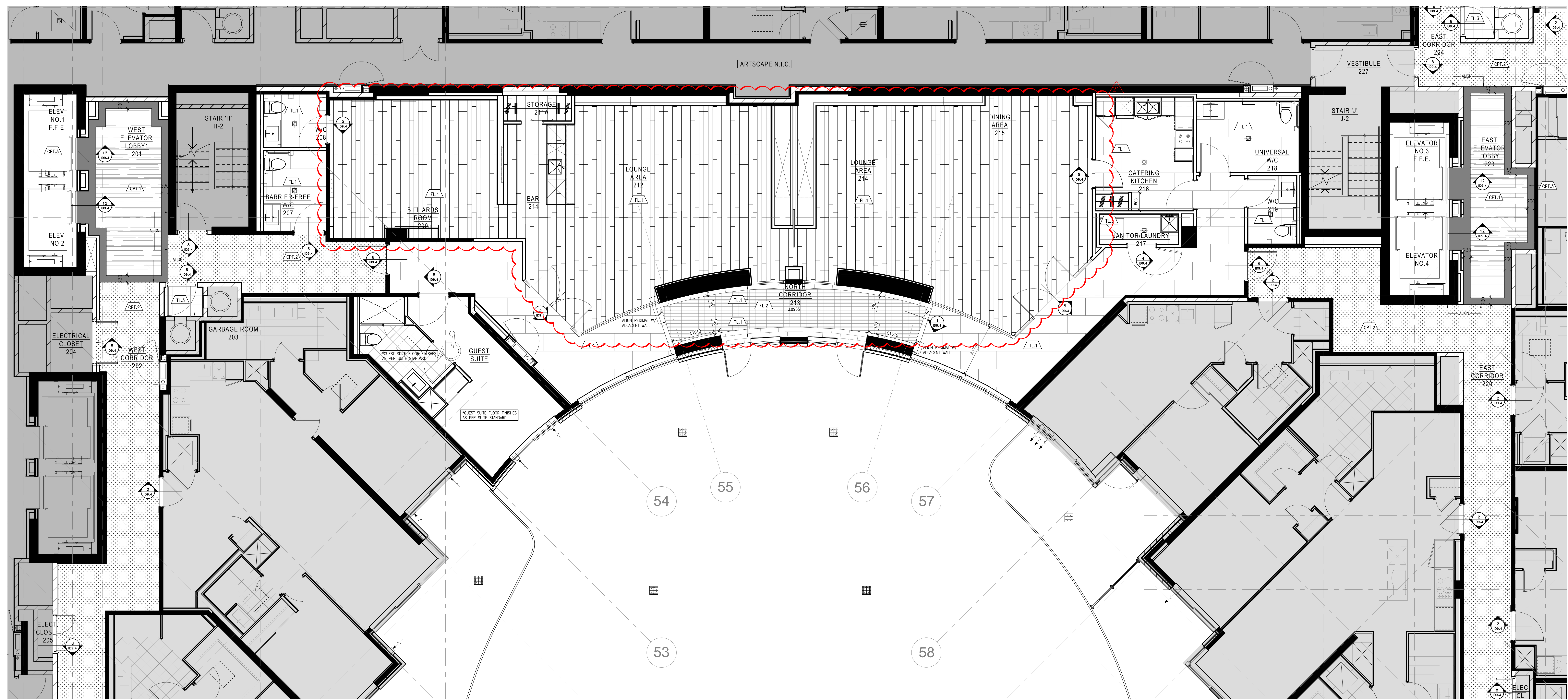

1 FLOOR FINISH PLAN
 07.8A SCALE 1:50

Hines TRIDEL

AQUAVISTA
 AT BAYSIDE TORONTO
 1 EDgewater Drive, Toronto Ontario

I BY IV
 DESIGN

77 MOWAT AVENUE, SUITE 100
 TORONTO, ONTARIO M5K 3G2 - CANADA
 T + 416 531 2224
 12 DEBORCHES STREET
 NEW YORK, NEW YORK 10013 - USA
 T + 212 362 4952

Drawing Title:
**LEVEL 2
 FLOOR FINISH PLAN**

Our Project Number:
 14008
 Designed By:
 DMJ/R, VW/SJ
 Detailed By:
 DMJ/R, VW/SJ, BP
 Drawing Number:

ID7.8A